

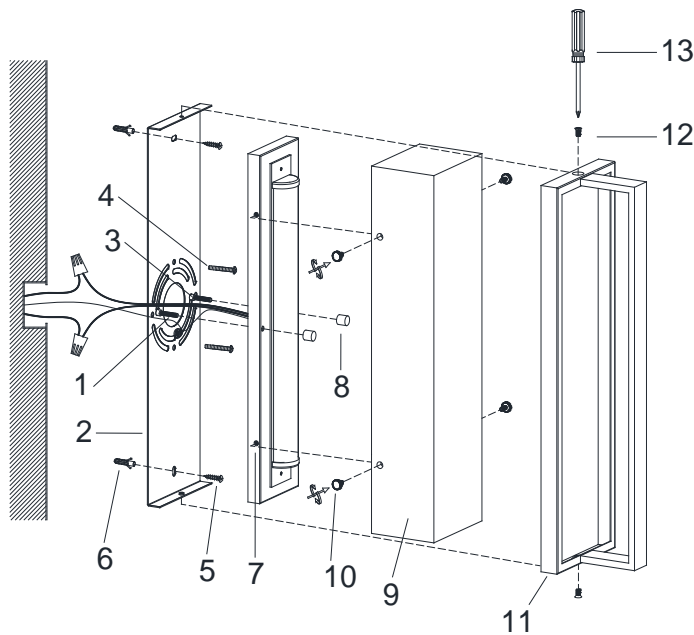

## ASSEMBLY AND INSTALLATION INSTRUCTIONS for the 661211 LED Fixture

### **Important Safety information (Please read before proceeding)**

1. Remove the fixture, parts and all mounting hardware bags (orange) from the carton and verify that all parts are present according to the illustration sheet. All parts must be used as indicated. Do not replace any parts, leave any parts out, or use any parts which are worn out or broken. **Failure to follow the instructions could cause a hazardous situation, voids the warranty and violates the U.L. listing of the fixture.**
2. To prevent the electric shock, turn off the main power at the circuit breaker before installing the fixture. **NEVER attempt to install, clean or replace bulbs without shutting off the electricity to the fixture.**
3. **Never use light bulbs with wattage ratings that exceed the fixtures maximum rating.** Always make sure the electric current is turned off before changing the bulbs.
4. If you experience difficulties installing the lighting fixture or it fails to work as expected, please contact a local qualified licensed electrical contractor.
5. Please contact your local Capital Lighting Fixture reseller with any assembly or installation questions. Your local reseller can also provide you with replacement parts for your new fixture.



### **Components**

1. Mounting Screws
2. Mounting Plate w/Green Screw
3. Hex Nuts (8/32IP)
4. Outlet Box Mounting Screws
5. Wood Screws
6. Plastic Anchors
7. Fixture
8. Cylinder Nuts
9. Faux Alabaster Shade
10. Thumb Screws
11. Décor Frame
12. Flat Head Mounting Screws
13. Philips Screw Driver (not provided)

### **Assembly Instructions for the 661211 LED fixture**

1. Assemble Mounting Plate (2) to mounting surface using hardware suitable for material of mounting surface. Mark position of holes on mounting surface before using provided Plastic Anchors (6), drill appropriate holes and assemble as illustrated.
2. Assemble Mounting Screws (1) into threaded holes of Mounting Plate (2), then screw Hex Nuts (3) in the front side of Mounting Plate (2).
3. Attach Mounting Plate (2) to Outlet Box with Outlet Box Mounting Screws (4), and to mounting surface with Wood Screws (5) tightly.
4. Raise Fixture (7) toward outlet box, wrap fixture grounding wire around Green Screw on Mounting Plate (2), then connect it to outlet box grounding wire with wire connector supplied; connect white fixture wire to the white power supply wire with wire connector supplied; connect black fixture wire to the black power supply wire with wire connector supplied.
5. Push Fixture (7) to wall, carefully passing Mounting Screws (1) through holes, verify all wires are securely inside fixture back plate, then Secure Fixture (7) to wall with Cylinder Nuts (8).
6. Cover Fixture (7) by Faux Alabaster Shade (9), make sure both holes in back plate of Fixture (7) and Faux Alabaster Shade (9) are in line, then secure them by Thumb Screws (10).
7. Push Decor Frame (11) to mounting surface, make sure mounting holes in Decor Frame (11) and Fixture (7) are in line, and carefully passing Flat Head Mounting Screws (12) through holes, then secure Decor Frame (11) to mounting surface with Flat Head Mounting Screws (12) and Philips Screw Driver (not provided) (13).